

OCEAN CITY'S "ST. LUCIE" REELS NOS. 934, 935, 979 AND 981
(Model B)

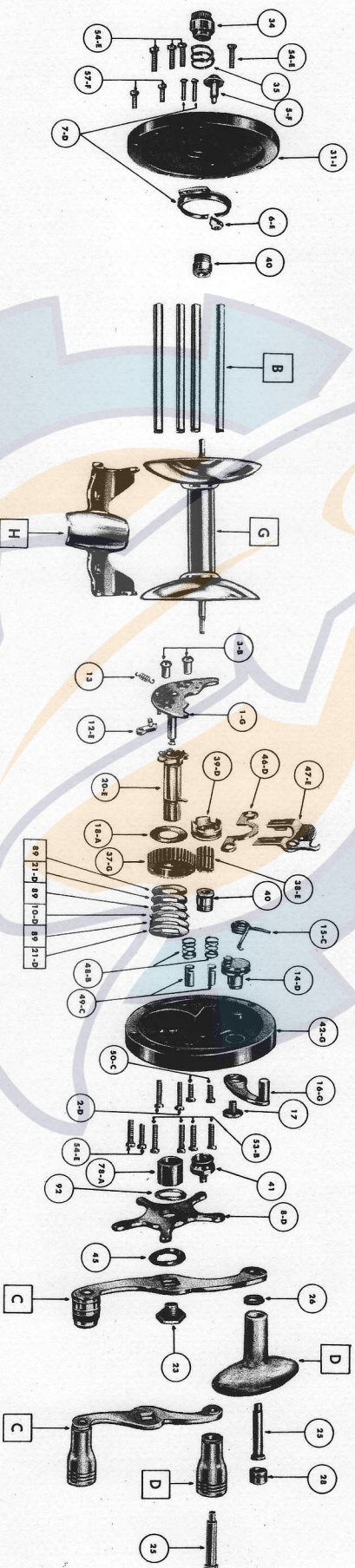

HOW TO ORDER PARTS FOR YOUR REEL—Locate the part desired in the illustration above and note part number, part name and model letter which you will find on underside of reel stand. Enclose money order, stamps or check. Our minimum charge for one order is \$2.50; please add \$.15 on each order for return postage and insurance.

PART No.	PART NAME	PRICE	PART No.	PART NAME	PRICE	PART No.	PART NAME	PRICE
1-G	Bridge	.30	14-D	Eccentric	.50	24-C	Handle Knob (for Models 934, 935, 981)	.24
2-D	Bridge Screw	.02	15-C	Eccentric Spring	.12	24-D	Handle Knob (for Model 979)	.14
3-B	Bridge Screw Nut	.04	16-E	Free Spool Lever	.24	25	Handle Knob Rivet	.06
5-F	Click Button	.12	17	Free Spool Lever Screw	.05	26	Handle Knob Oiler	.01
6-E	Click Pawl	.08	19-K	Frame Post (Models 934, 935)	.14	28	Handle Knob Fall Washer	.24
7-D	Click Spring and Rivets	.14	19-H	Frame Post (Model 979)	.12	23	Left Side Plate Complete with Part Nos. 5-F, 7-D, and 6-E	.50
12-E	Drag Dog	.10	19-I	Frame Post (Model 981)	.12	31-I	Left Side Oil Cap Spring	.12
13	Drag Dog Spring	.03	20-E	Gear Sleeve and Lock Pin	.60	34	Left Side Oil Cap	.04
18-A	Drag Fiber Washer	.01	78-A	Gear Sleeve Bushing	.08	35	Left Side Oil Cap Spring	.20
89	Drag Laminated Washer	.02	22-G	Handle Complete with Part Nos. 24-C, 25, 26, and 28 (for Models 934, 935, and 981)	.80	40	Main Gear	.75
21-D	Drag Lock Washer	.05	22-H	Handle Complete with Part Nos. 24-D, and 25 (for Model 979)	.80	37-G	Pinion Gear	.30
10-D	Drag Eared Washer	.05				38-E	Pinion Gear Cutch	.26
92	Drag Star Bottom Washer	.04				39-D	Right Side Cutch	.50
45	Drag Star Top Washer	.04				42-G	Right Side Adjusting Cap	.12
8-D	Drag Star	.32				41		

Above handles can be used on all four models

PART No.	PART NAME	PRICE	PART No.	PART NAME	PRICE
44-T	Spool (for Model No. 935)	1.00	43-B	Stand (for Models 934, 935)	.80
44-S	Spool (for Model No. 934)	1.20	43-Q	Stand (for Model No. 979)	.60
44-D	Spool (for Model No. 979)	1.00	43-R	Stand (for Model No. 981)	.60
44-R	Spool (for Model No. 981)	1.00			
53-B	Screw, Right Side Plate	.02	54-E	Screw, Right Side and Left Plate	.02
54-E	Screw, Right Side and Left Plate	.02	57-E	Yoke Plate	.28
57-E	Yoke Plate	.28	46-D	Yoke	.16
46-D	Yoke	.16	48-B	Yoke Spring	.04
48-B	Yoke Spring	.04	49-C	Yoke Guide Stud	.06
49-C	Yoke Guide Stud	.06	50-C	Yoke Guide Stud Screw	.02